

Designed TO RESIST

ASSEMBLY GUIDE
AND EXAMPLES



FORMS AND FORMATS

MONO

Edge height 40 mm, Standard length 5600 mm

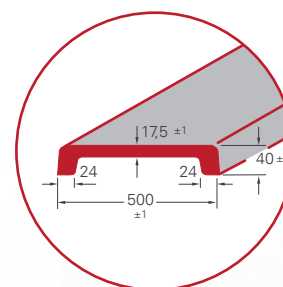
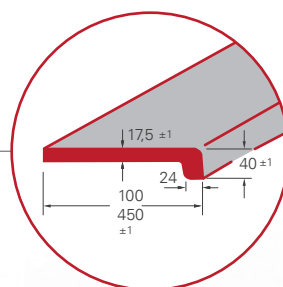

SLIMLINE

Edge height 25 mm, Standard length 5600 mm

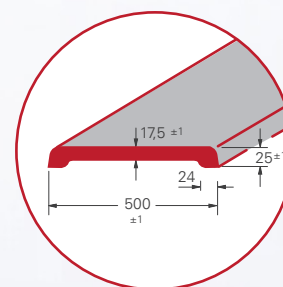
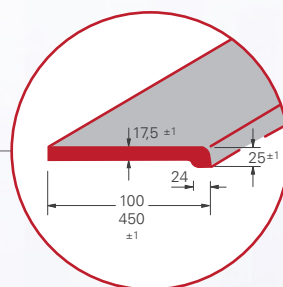

MORE

Bezel available in different heights,
Standard length 4400 mm

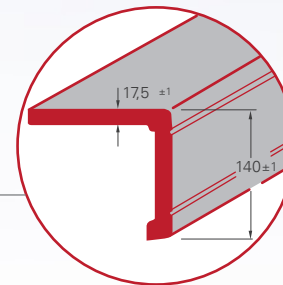
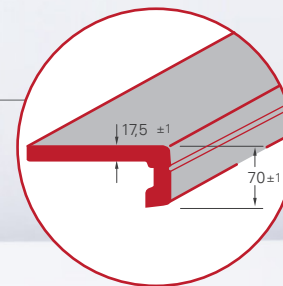
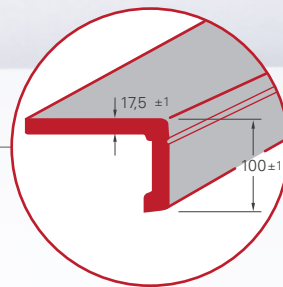
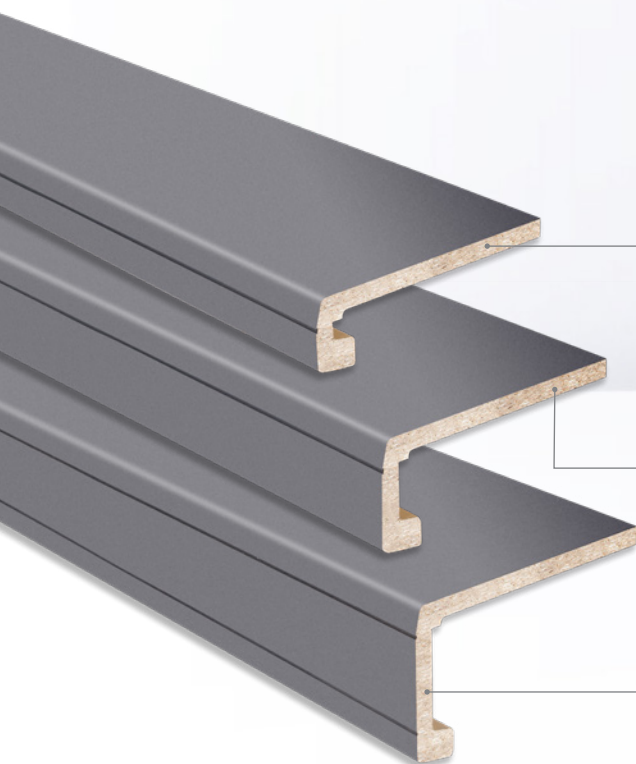

ASSEMBLY GUIDE/EXAMPLES

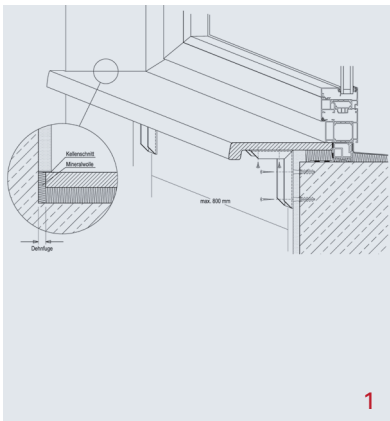

1

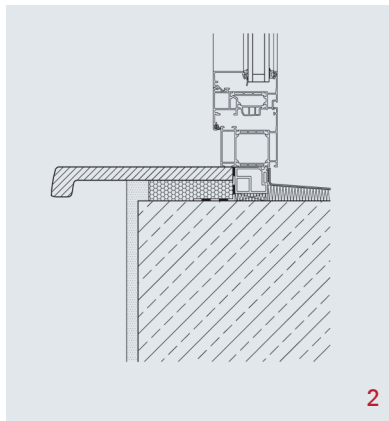

2

Image 1

Fastening on brackets.
Bracket spacing max. 800 mm.

Note on image 1: When plastering, a sliding material (e.g. foil) can be inserted between the windowsill and the plaster edge to prevent the plaster edge from tearing off in the event of length changes. The expansion joint (1.5 mm/rm) must be filled with insulation wool before plastering the reveal.

Image 2

Fastening with 2-component assembly foam.

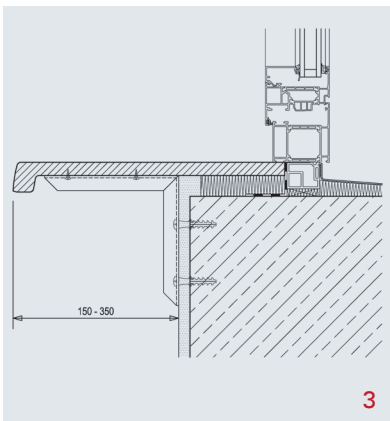

3

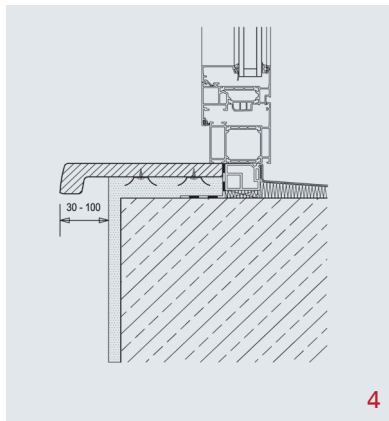

4

Image 3

Adhesive mounting with additional brackets.

Image 4

Fastening of the window sill with wall claw in the mortar bed.

up to 1200 mm length	2 pieces
up to 1800 mm length	3 pieces
up to 2400 mm length	4 pieces
etc.	

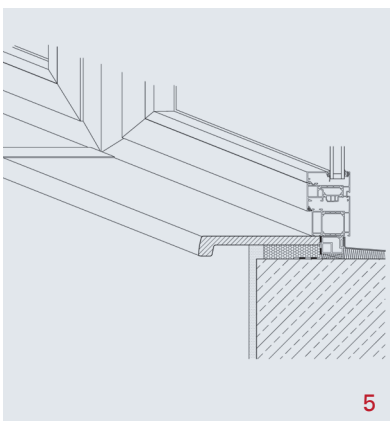

5

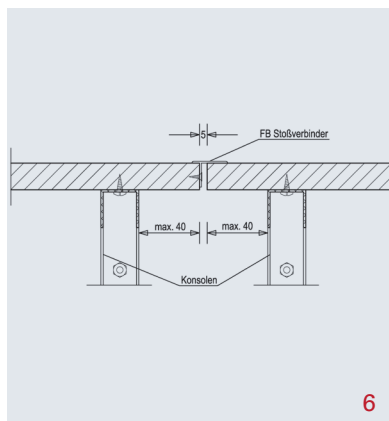

6

Image 5

Butt joints are made with the window sill connecting profile.

Image 6

Detail butt joint: Expansion joint at least 5 mm. Fasten windowsill butt joint with Spax screws 3.0 x 20 mm. Bracket distance to window sill max. 40 mm, if possible, mount a wide center bracket under the butt joint.

Please note

Spacing of the fastening elements max. 800 mm, free projection above the last fastening point = max. 100 mm. Stainless steel cylinder sheet metal screws 3.9 x 16 mm are used for screwing. The possible change in length of the windowsill must be taken into account during fastening, e.g. by means of slotted holes or larger holes in the support brackets.

When mounting in groove, the window sill must be folded accordingly to compensate for possible thickness tolerances. When gluing, plastering or foaming in, it is essential that the window sills are aligned flat and clamped until they harden (spread, weigh down).

ASSEMBLY GUIDE/EXAMPLES

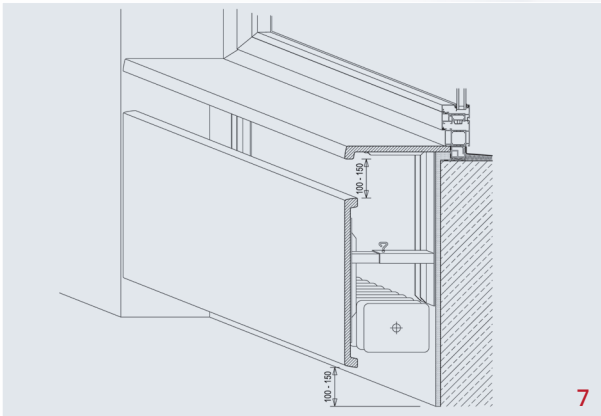

Image 7

Fixing the window sill on telescopic bracket, at the same time vertical mounting of a double profile as a convector cladding.

Please note

Spacing of the fastening elements max. 800 mm, free projection above the last fastening point = max. 100 mm. Stainless steel cylinder sheet metal screws 3.9 x 16 mm are used for screwing.

The possible change in length of the windowsill must be taken into account during fastening, e.g. by means of slotted holes or larger holes in the support brackets. When mounting in groove, the windowsill must be folded accordingly to compensate for possible thickness tolerances.

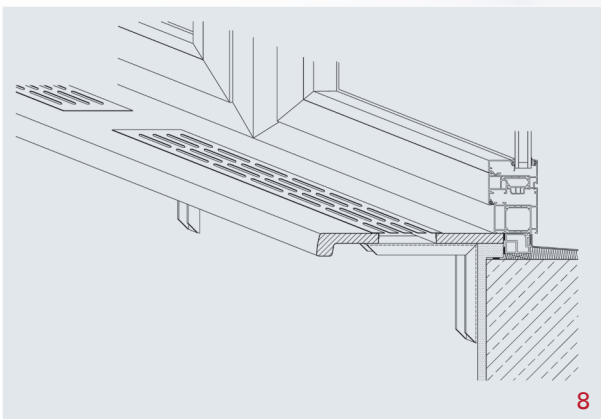

Image 8

Fixing of window sill on console, with windowsill ventilation profile. Ventilation grille cut-out size 766 mm, glue grille with silicone.

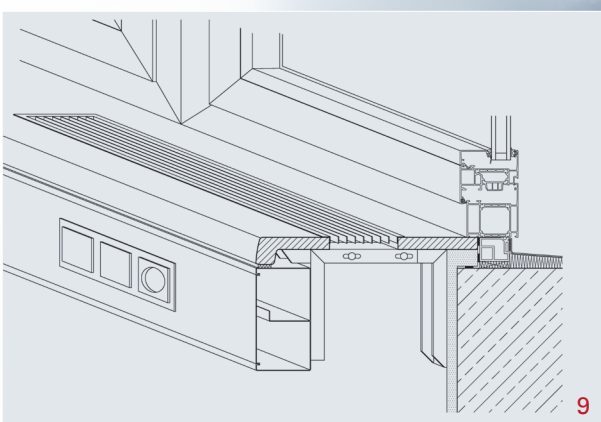
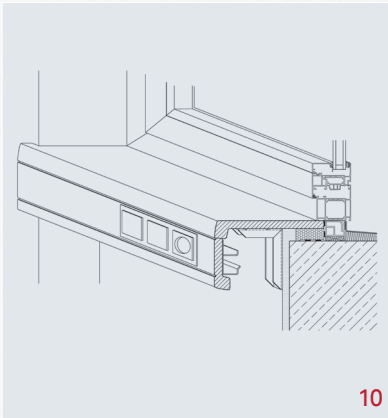

Image 9

Fastening of the windowsill with standard installation channel and continuous aluminum linear grating. Mounting on adjustable brackets.



ASSEMBLY GUIDE/EXAMPLES



10

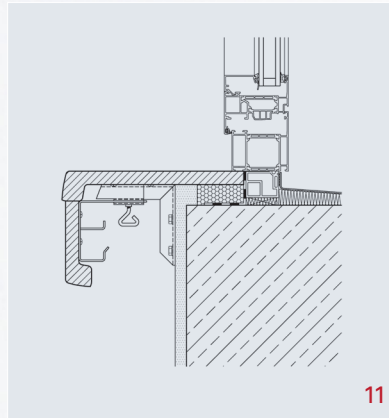

11

Image 10

Fixing of the system windowsill with fixed panel incl. cable duct. Mounting on brackets.

Image 11

Fastening of the removable bezel with mounting bracket and screw lock.

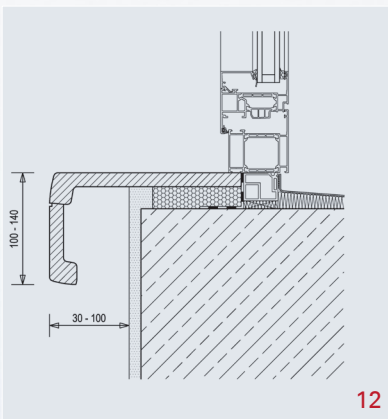

12

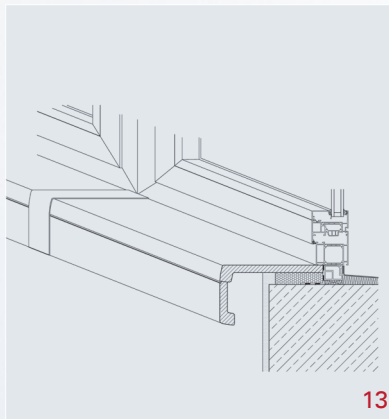

13

Image 12

Fixing the system window sill with 2-component mounting foam.

Image 13

Detail butt joint for system window sill with fixed fascia.

Mounting removable cover

Connection is made with bracket and screw lock. Easy disassembly for laying new cables etc., distance between brackets max. 600 mm.

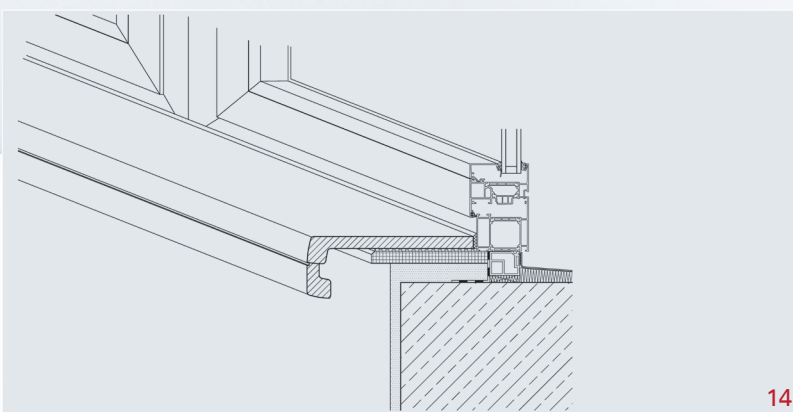

14

Image 14

Mounting overlay-windowsill

System windowsill with fixed panel 70 mm as overlay-sill on existing windowsill, fastening depending on conditions by gluing, foaming or, if possible, by screws through the old windowsill from below.

Please note

Spacing of the fastening elements max. 800 mm, free projection above the last fastening point = max. 100 mm. Stainless steel cylinder sheet metal screws 3.9 x 16 mm are used for screwing. The possible change in length of the windowsill must be taken into account during fastening, e.g. by means of slotted holes or larger holes in the support brackets. When mounting in groove, the windowsill must be folded accordingly to compensate for possible thickness tolerances.

When gluing, plastering or foaming in, it is essential that the windowsills are aligned flat and clamped until they harden (spread, weigh down).

General Information

These General Terms and Conditions of Business (hereinafter referred to as „GTC“) shall apply to all contracts concluded between the work orderer, customer or principal (hereinafter referred to as „customer“) and Topalit GmbH with regard to our goods and/or services, in particular purchase contracts, contracts for work and services or other commissioned services (transport, assembly, etc.). The inclusion of the customer's own terms and conditions is hereby objected to unless otherwise agreed. If Topalit GmbH has a longer business relationship with the customer, these General Terms and Conditions shall apply even if their validity is not specifically referred to. The GTC shall also apply to subsequent orders, even if they are not separately agreed verbally or in writing. Employees of our company are prohibited from making any promises that deviate from these terms and conditions. Verbal agreements shall only be effective if they are confirmed in writing by Topalit GmbH.

Quotations

Our offers are subject to change without notice; in particular, we reserve the right to make intermediate sales and economically justified price increases. All orders and agreements, especially those mediated by our representatives or other agents, require written confirmation. Our order confirmation shall be deemed to be accepted in its full content if the customer does not complain to us within five working days after receipt of the confirmation. The postal route will be included. Any change in the cost situation, in particular of raw materials, wages, etc., allows us to adjust the prices without prior information to the customer. In the event of subsequent changes to orders by the customer, a change fee in the amount of € 50.00 must be paid. If the order confirmation signed by the customer differs from his order, the order confirmation shall prevail in case of doubt. Unless otherwise stated in our product description, the prices quoted are total prices which include the statutory value added tax. Any additional delivery and shipping costs will be indicated separately in the respective product description. We reserve the right to charge a surcharge of EUR 40,- for orders below the minimum amount of EUR 200,- net.

Delivery

Delivery shall be made for the account and at the risk of the customer and, unless otherwise agreed, to the customer's delivery address. The choice of shipping method is at our discretion. Our prices are packed ex works Ampflwang / Upper Austria. The shipment can, insofar as this is necessary, also be made from an external storage or loading location at our discretion. For special packaging, the entire costs incurred must be borne by the customer.

Delivery Time

The delivery time is stated in each case without guarantee, depending on the fabrication and delivery conditions and, in the case of custom-made products, depending on the timely receipt of the corresponding pressing tool and its perfect functioning. In the case of an agreed delivery time, this will be adhered to as far as possible; a claim for damages by the customer due to negligent delay in delivery is excluded. This also applies to deliveries of commercial goods.

In the event of force majeure or official measures, we shall be entitled to withdraw from the contract in whole or in part or to extend the delivery period by the duration of the hindrance, but by no more than six months. This shall only apply if we have informed the customer of the extension within the first four weeks after the occurrence of the hindrance. Circumstances for which we are not responsible, such as shortage of raw materials, strikes and lockouts in the course of economic disputes, sabotage and riots, as well as traffic and operational disruptions due to other causes, shall be deemed equivalent to force majeure.

Complaints

Notification of defects must be made in writing by the customer after proper inspection upon acceptance of the goods at the place of destination, specifying the alleged individual defects in detail, namely

- a) for obvious defects within 14 days after receipt of the goods,
- b) for hidden defects within 14 days after receipt of the goods, but not later than within three months.

No notice of defects shall be accepted for any other obvious or hidden defects occurring after the goods have been processed. The time limit for the notification of defects shall not be extended by any postal delivery time. The customer's obligation to inspect the goods shall extend to the entire delivery after the goods have arrived at their destination. If the customer wishes to claim defects, the processing or treatment of the goods must be refrained from or must be stopped immediately if hidden defects are detected. Any consequential damage caused by a defect, in particular consequential damage caused by a production stoppage, in particular financial loss and loss of profits, shall be the sole responsibility of the customer and cannot be claimed against Topalit GmbH, in particular in the case of only negligently caused defects of goods manufactured by Topalit GmbH. The contestation of error due to the defect itself or due to any consequential damage caused by the defect is also excluded.

In the event of a justified and timely notice of defect, the customer may only demand a price reduction; other claims for improvement, subsequent delivery, replacement, rescission or damages due to non-performance as well as due to positive breach of contract and error regarding the defect-free nature of the item itself or regarding consequential damage caused by the defect are excluded. The customer shall bear the full burden of proof for all preconditions for a claim, in particular for the defect itself, the time of discovery of the defect and the timeliness of the notice of defect. In all cases, we are entitled to demand the return of the goods or to demand replacement. If the customer does not give notice of the defect in due time, the customer shall lose all warranty claims, claims for damages and claims for error on account of the defect itself and any consequential damage caused by the defect. In the event of a timely but unfounded notice of defect, the customer shall also lose all of the above-mentioned claims if he does not improve the notice of defect before the expiry of the 14-day notice period.

Compensation for storage charges is excluded in any case. In all cases, claims of the customer are only possible up to the total value of the goods delivered by us. The customer has no claims beyond this. Deviations of up to 10% in the ordered quantities and strengths do not constitute grounds for a notice of defects. In the event of defects occurring, the goods must be kept at the place of destination for at least as long as this ensures that the circumstances can be fully clarified and the facts thoroughly established. In any case, insufficient documentation of defects shall be at the expense of the customer. Our limit samples and internal specifications are decisive for all defects.

Payment Method

The invoice is issued on the date of delivery or provision of the goods; net payment targets can be assigned on the basis of internally assigned limits. The generally applicable rules of SEPA payment transactions apply here. For orders above this defined limit, a down payment in the amount of the relevant pro forma invoice must be made no later than one working day before the delivery date or provision date. If this down payment is not made, Topalit GmbH reserves the right to withdraw from the contract without further information to the customer. In the event of late payments, interest on arrears amounting to 8 % shall be charged. In addition, reminder fees and storage costs shall be charged on a mandatory basis in the event of late collection. Unauthorized cash discounts will be reclaimed without exception. Before full payment of due invoice amounts including interest on arrears, we are not obligated to make any delivery or to make any further deliveries. If the customer is in default with the payment of a claim, then all claims existing against him become due. In the event of default in payment, we shall be entitled to withdraw from the contract in whole or in part and to demand securities in the form of advance payments before delivering further consignments.

Payment shall be made by bank transfer. Offsetting against counterclaims disputed by us, retention due to alleged but not acknowledged bad delivery, as well as deductions for packaging and freight are inadmissible. Discount and collection charges are to be reimbursed by the customer as cash expenses immediately with the payment. In the case of deliveries abroad, the customer shall, unless otherwise agreed, deposit an irrevocable and confirmed letter of credit in the amount of the pro forma invoice relating to the order with Raiffeisenbank Region Vöcklabruck to secure payment.

Retention of Title

The delivered goods remain our property until payment has been made. Pledging or transfer of ownership by way of security of these goods in favor of third parties is excluded without our consent. In the event of seizure by third parties, the customer must notify us immediately. In the event of mixing or processing of the goods, the customer hereby assigns to us his ownership or co-ownership rights to the mixed stock or to the new object and shall keep our property for us with due commercial care.

Custom of Trade

In addition to these terms and conditions, the trade customs established by the Austrian Federal Economic Chamber shall be deemed agreed. They and our terms and conditions of sale, delivery and payment are the content of every sales contract concluded by us with the customer. All amendments or supplements to our present terms and conditions of sale, delivery and payment shall require our express written confirmation in order to be effective. Any deviation

therefrom shall also require our express written confirmation. Verbal subsidiary agreements, in particular those by which the form of the written confirmation is to be waived, modified or supplemented, shall be ineffective in any case. The invalidity of any individual provision of these Terms and Conditions of Sale, Delivery and Payment shall not affect the validity of the remaining provisions.

Place of performance and jurisdiction

Place of performance for the services of both contracting parties is Ampflwang / Upper Austria.

The purchase contract shall be governed by the applicable Austrian law, excluding the UN Convention on Contracts for the International Sale of Goods. All disputes arising from sales of goods, bills of exchange, letters of credit or checks between the customer and us shall be governed exclusively by the laws of the Republic of Austria.

For all disputes arising from the sale of goods, bills of exchange, letters of credit or checks between the customer and us, it is agreed that the exclusive place of jurisdiction shall be the Regional Court of Wels. We reserve the right to take legal action at the customer's place of business or at another place of jurisdiction instead.

TECHNICAL DATA

		Topalit Indoor-Window sill		Test Standard
1.	Density	700-800	kg/m ³	EN 323
2.	Flexural strength	30-35	N/mm ²	EN 310/EN 438
3.	Modulus of elasticity	3500-5000	N/mm ²	EN 310/EN 438
4.	Transverse tensile strength(internal bond strength)	1,0-2,0	N/mm ²	EN 319
5.	Screw pull-out strength	800-1300	N	Topalit Standard ¹⁾
6.	Swelling after water storage at 20 °C after 2 h after 24 h	0,3-0,6	%	EN 317
		2,0-5,0	%	EN 317
7.	Moisture content	5-10	%	EN 322
8.	Temperature resistance long-term stress short-term stress	-50 bis +90	°C	Topalit Standard
		+180	°C	
9.	Fire behavior	Standard version (formerly normal flammability B2) flame retardant possible on request	D-s2,d0	DIN EN 13501-1
			B1	DIN 4102
10.	Change in length due to moisture and heat	1-3	mm/m	Topalit Standard
11.	Thermal conductivity I 10	0,13	W/mK	DIN 52 612
12.	Scratch hardness	3-5,5	N	EN 438
13.	Abrasion resistance XD surface	450-600	U	EN 438
14.	Light resistance	Level 6-8		EN 438
15.	Chemical resistance	good to excellent		EN 438
16.	Cigarette burn resistance	glow resistant		EN 438
17.	Resistance to hot pot bottoms	resistant Level 5		EN 438
18.	Free formaldehyde	0,011	mg/kg	EN 717

¹⁾ 4mm Spax screw, screwed into 3mm diameter hole, 10mm deep.

Designed
TO RESIST

This technical data sheet can and should only provide non-binding advice. We ask that all information on working with our products be adapted to local conditions and the materials used. For further technical information, please refer to our respective individual brochures. Status: January 2023

Edition 1 / 2023 / 91224

Reprinting or other reproduction, including excerpts only with the permission of the publisher. Misprints and technical changes reserved.

R U P . a t